

# Card Hub

Manage your debit cards in the First Bank Mobile App

# CardHub: Features



## Controls & Alerts

- Card On/Off
- Location
- Merchant Type
- Transaction Type
- Spend Limits
- Alerts
- 2-Way Fraud Alerts



## View Transactions & Details

- Transaction History
- Account Balance
- Account Status
- Statements



## Spend Insights

- What, When, Where
- Card on File
- Recurring Payments



## Self-Service

- Activate Card
- Report Lost/Stolen
- Travel Plan\*
- Set PIN



## Digital Payments

- Push Provisioning\*
- View Digital Card

\*Features may slightly vary depending on your solution set with Fiserv

## Turn Card On or Off in CardHub

First Step is to activate your cards in the app.

You can have multiple cards: for example yours and your spouses or children

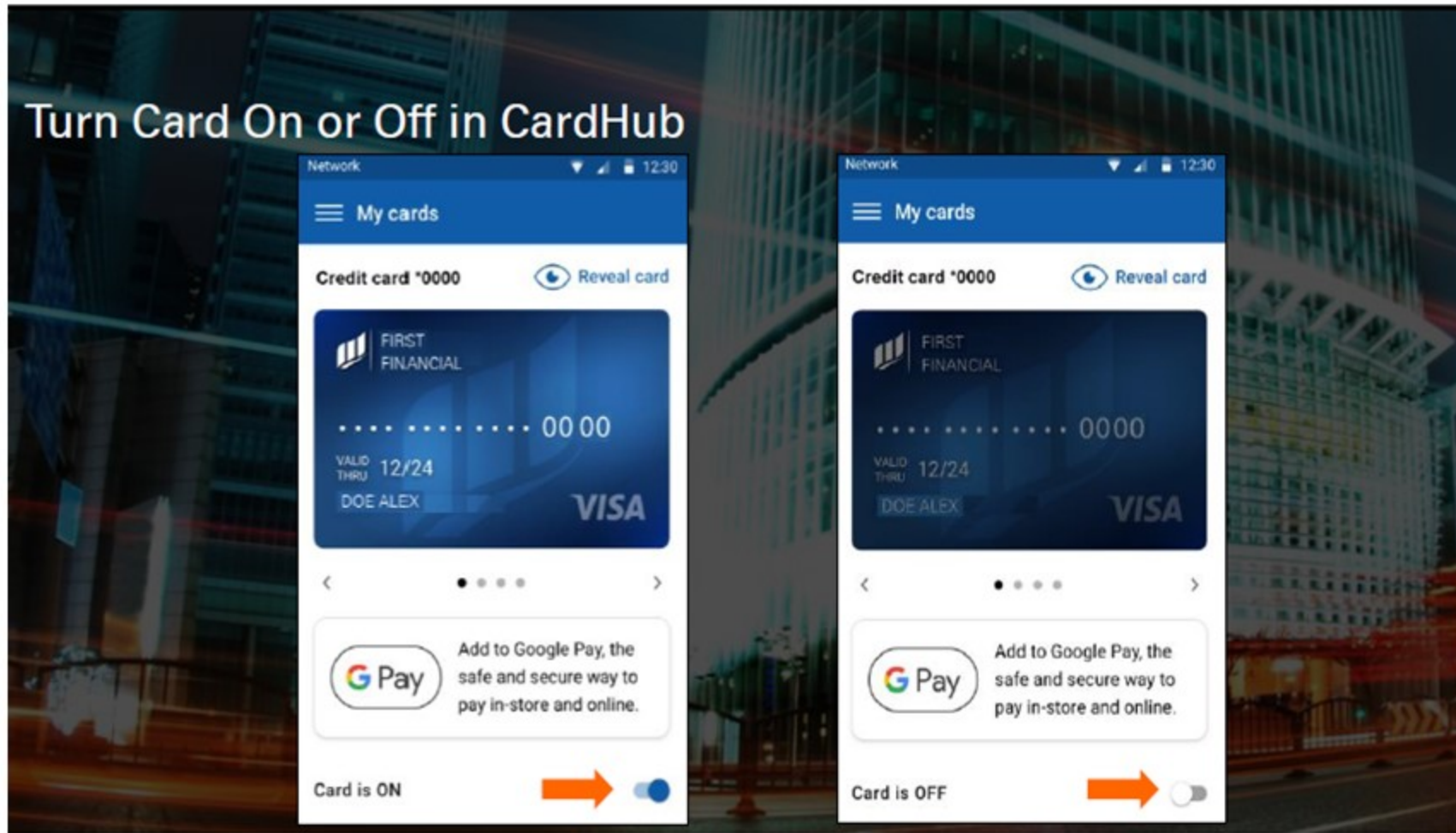

# Transactions

Main Screen shows 3 most recent.  
Can Click on view all to see more

Click individual transactions to see  
more information

## Transactions in CardHub

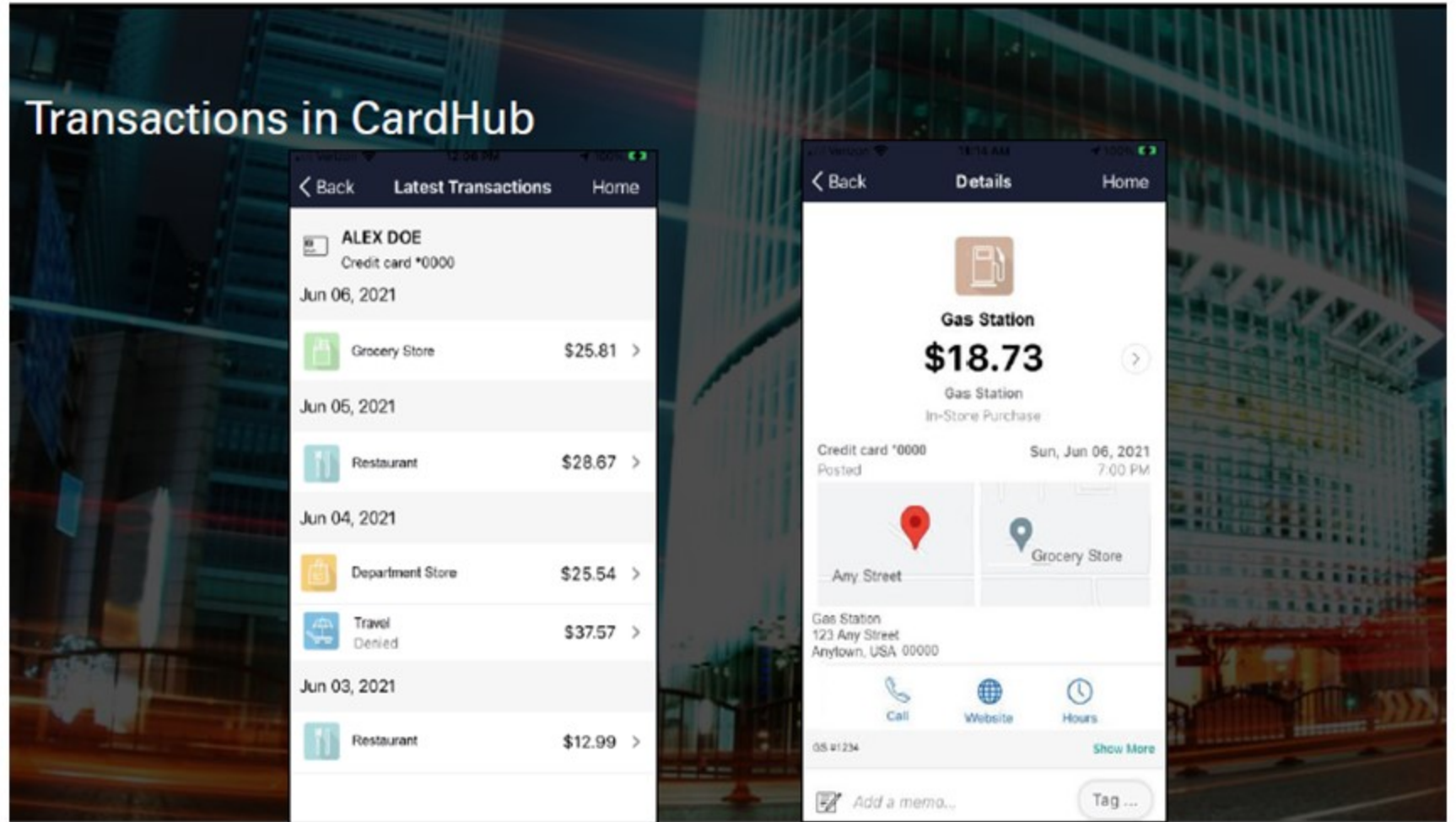

# Digital Card

To use your card online when you don't physically have your card.

## View Digital Card in CardHub

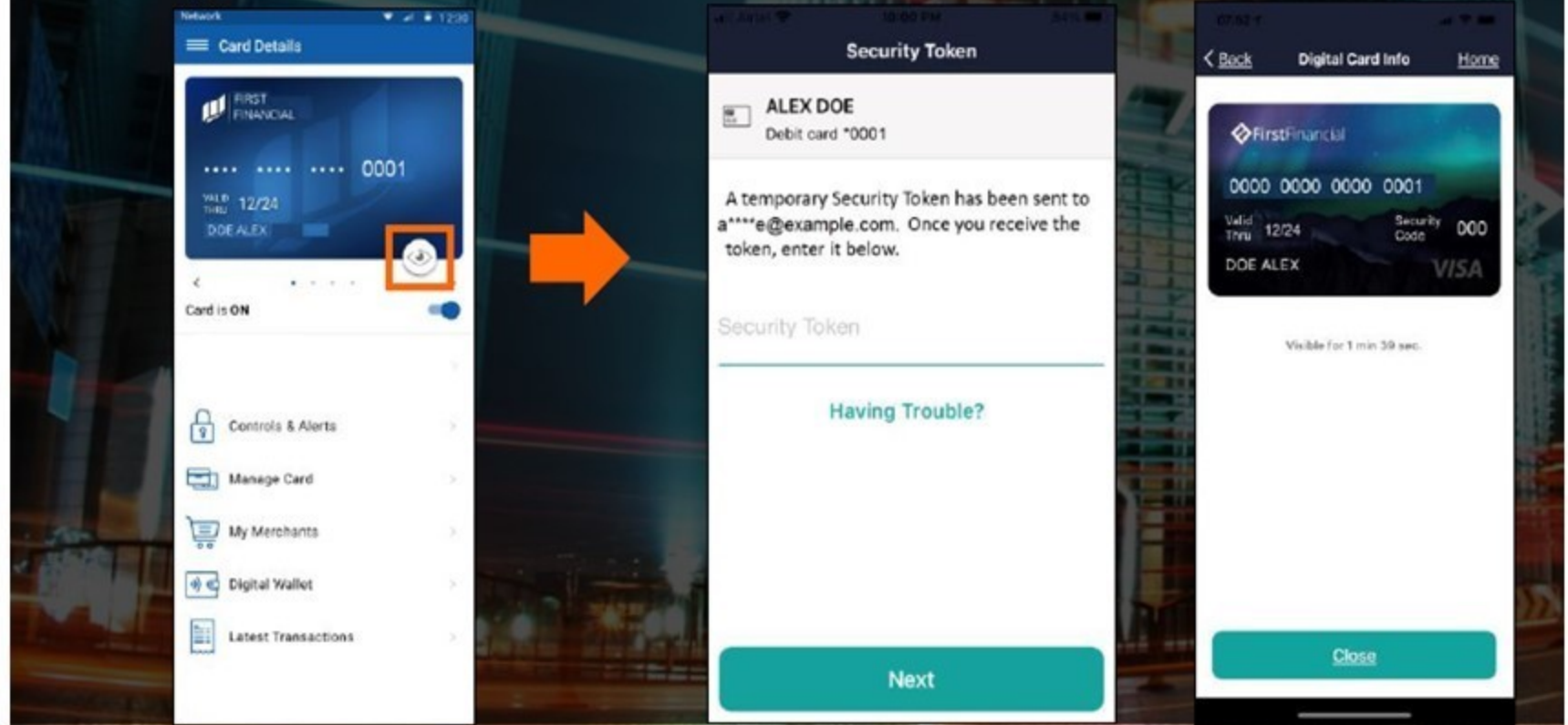

# Spend Insights

Keep in Mind this is spend activity on your card, not necessarily your account as a whole.

## Spend Insights in CardHub

**Card details**

- Spend insights
- Card on file

**Manage card**

- Controls & Alerts
- Travel plan
- Manage PIN

**My Spend**

JUN 2021  
**\$155.49**

Spend Summary

Total Spend (excludes recurring transactions)	\$131.36
Recurring Spend	\$24.13
Credits	\$0.00

WHAT WHEN WHERE

Grocery  
**\$45.71**

May Jun Jul Aug Sep Oct

Latest Transactions

Grocery	1 Transaction	\$45.71
Score 1		\$45.71

**My Spend**

JUN 2021  
**\$155.49**

Spend Summary

Total Spend (excludes recurring transactions)	\$131.36
Recurring Spend	\$24.13
Credits	\$0.00

WHAT WHEN WHERE

\$170.21 \$155.49

May Jun Jul Aug Sep Oct

Latest Transactions

June 2021	7 Transactions	\$155.49
May 2021	7 Transactions	\$170.21

**My Spend**

JUL 2021  
**\$145.10**

Spend Summary

WHAT WHEN WHERE

Transactions on Map

Ohio	1 Transaction	\$28.79
California	1 Transaction	\$5.71
Texas		\$32.60

## Recurring Payments in CardHub

# Card on File

### Two Options

Recurring Payments: subscriptions you have tied to your card.

Card on File: Merchants that have your card information. Example: Store Apps.

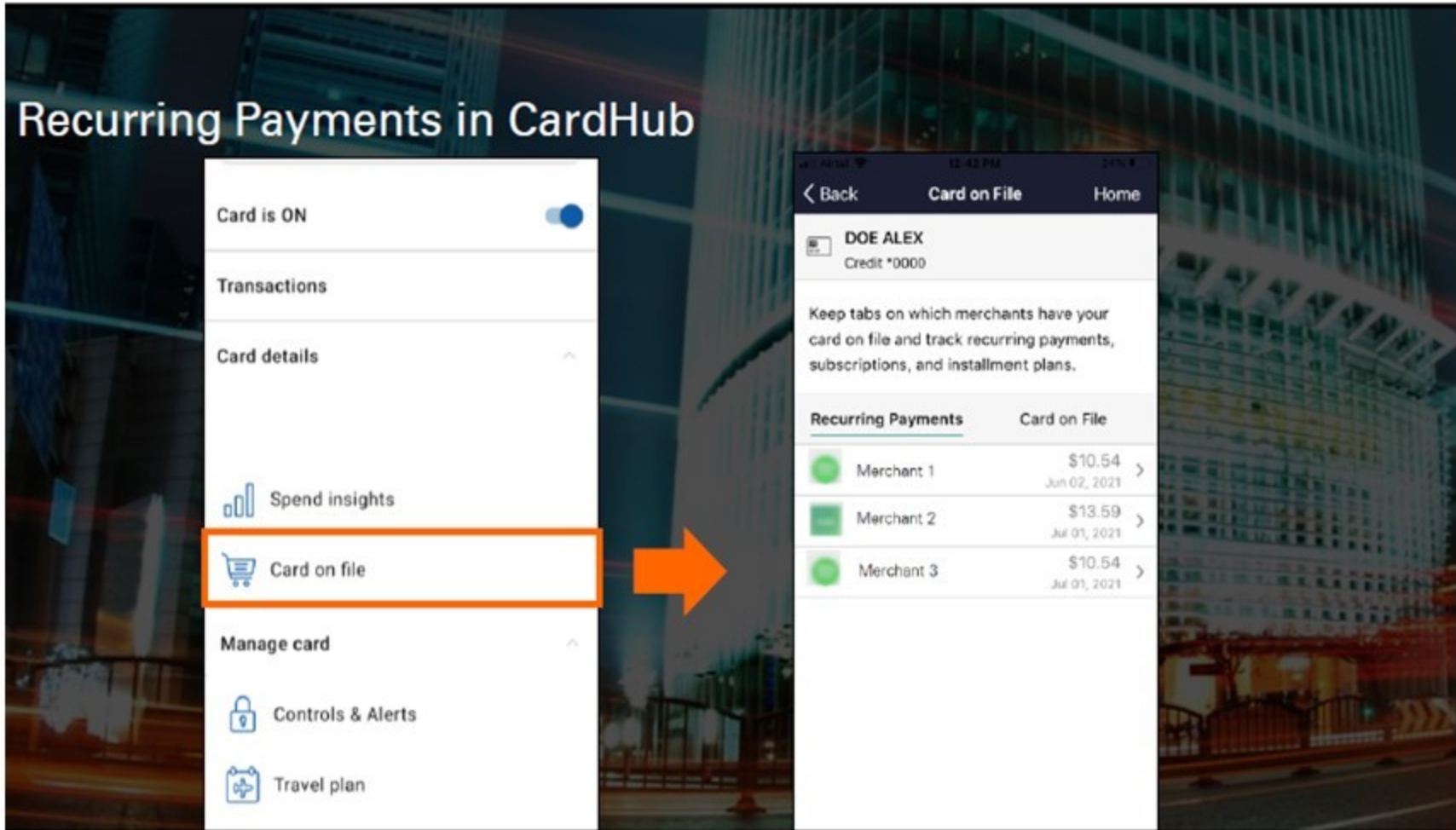

# Controls

Can set controls on spending based on location, merchant types, transaction types, and/or dollar amounts

This for the debit card not your account as a whole.

## Controls in CardHub

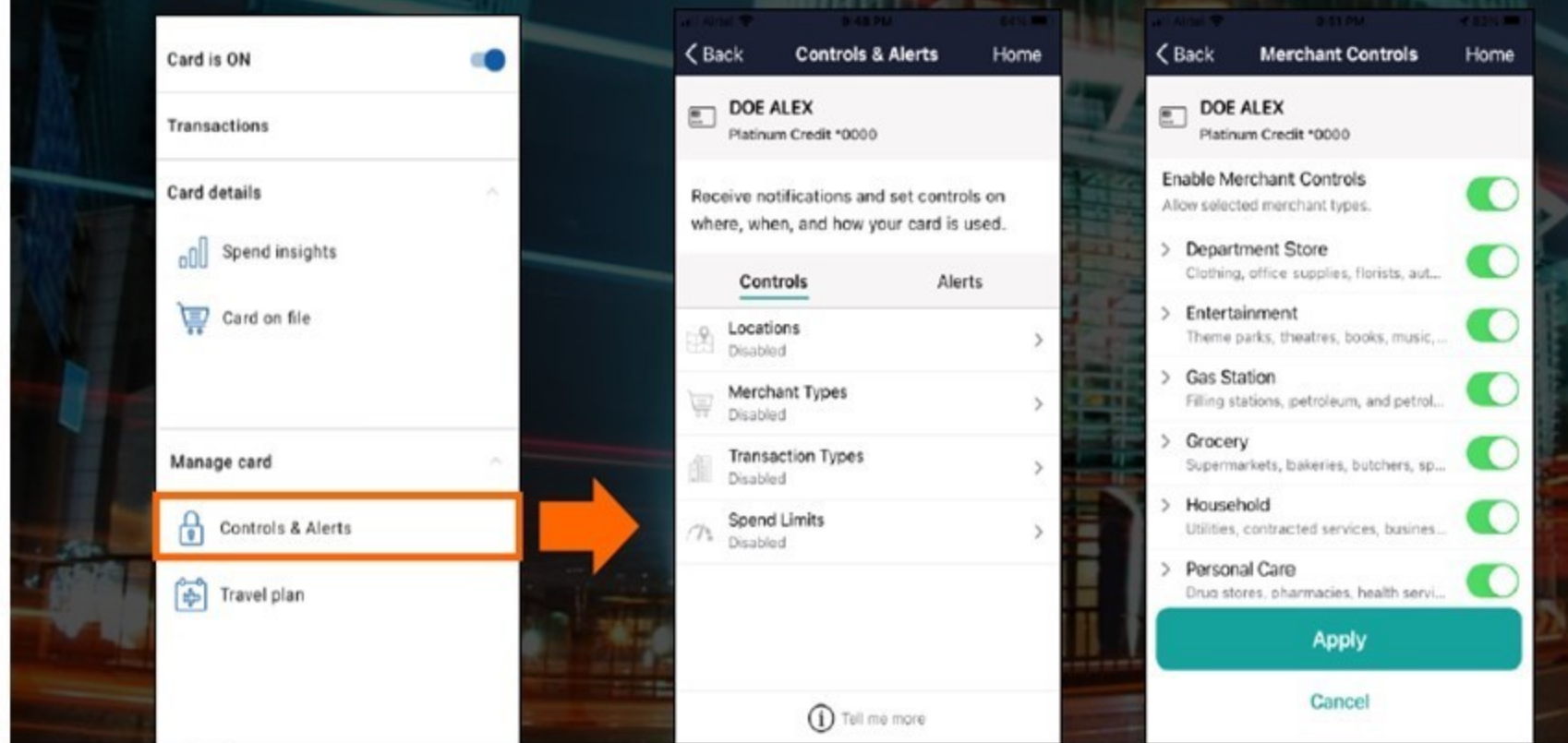



## Controls in CardHub (continued)

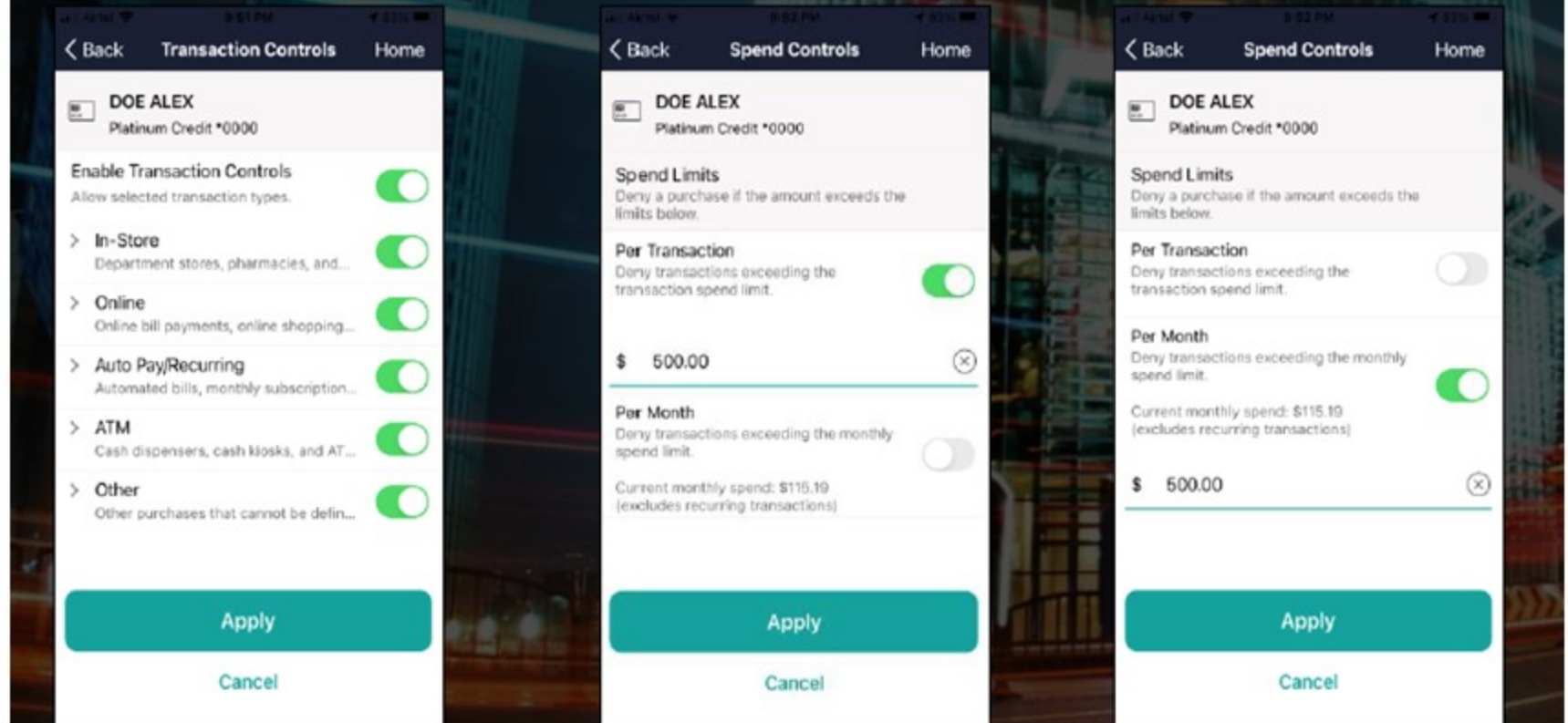

# Alerts

Can enable alerts based on locations, merchants, transactions, or dollar amount.

These are based on card activity not account.

## Alerts in CardHub

The image displays four sequential screenshots of the CardHub mobile application interface, illustrating the process of enabling alerts for a credit card. The cardholder's name is identified as DOE ALEX with a credit limit of \*0000.

- CardHub Home:** The main menu shows options like "Card is ON", "Transactions", "Card details", "Spend insights", "Card on file", "Manage card", "Controls & Alerts" (highlighted with an orange box), and "Travel plan".
- Spend Alerts:** This screen allows setting dollar-based alerts. It includes sections for "Spend Limits" (Alert me if the amount exceeds the limits below), "Per Transaction" (Alert me when a transaction exceeds the transaction spend limit), and "Per Month" (Alert transactions exceeding the monthly spend limit). The current monthly spend is \$27.15. A limit of \$ 500.00 is set.
- Merchant Alerts:** This screen allows enabling alerts for specific merchant categories. Categories include Department Store, Entertainment, Gas Station, Grocery, Household, and Personal Care. The "Enable Merchant Alerts" toggle is turned on.
- Transaction Alerts:** This screen allows enabling alerts for specific transaction types. Categories include In-Store, Online, Autopay/Recurring, ATM, and Other. The "Enable Transaction Alerts" toggle is turned on.

Each settings screen includes an "Apply" button and a "Cancel" button.

15 © 2021 Fiserv, Inc. or its affiliates. | FISERV CONFIDENTIAL

FORTUNE World's Most Admired Companies® 2014 | 2015 | 2016 | 2017 | 2018 | 2019 | 2020 | 2021 **fiserv.**

# Travel Plans

## Travel Plan in CardHub

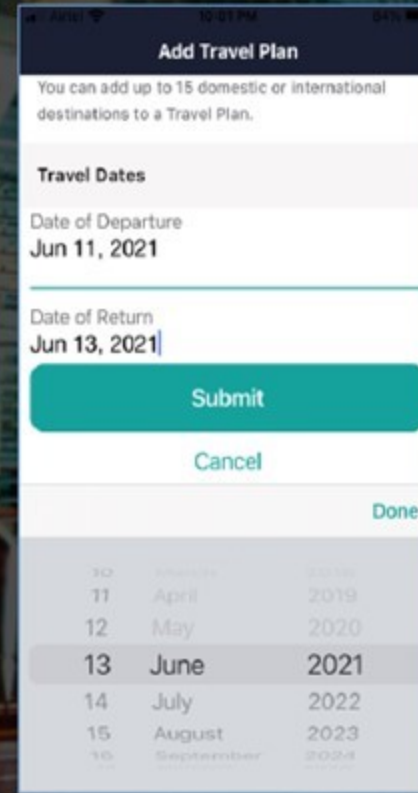
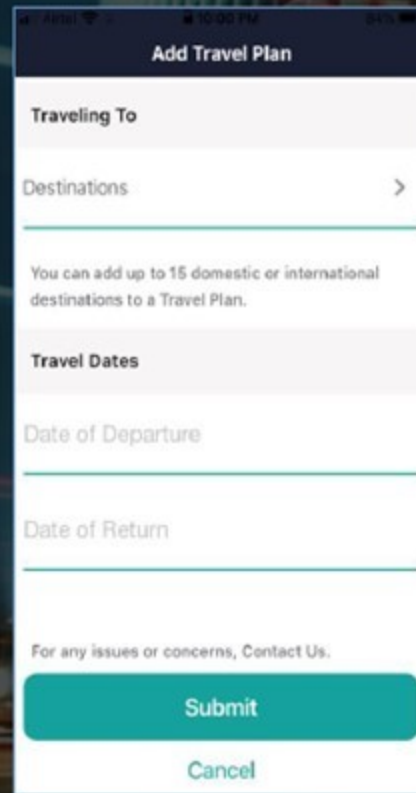
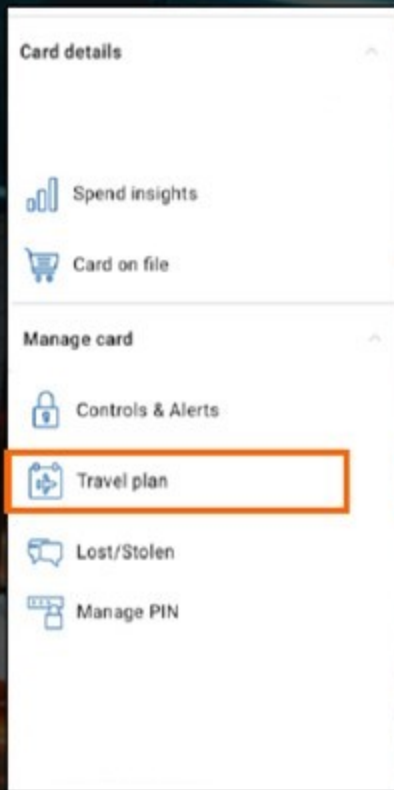

# Digital Wallet

Can add your card to your digital wallet from here as well.

## Push Provisioning in CardHub

